

Terumo® Surflo® Straight I.V. Catheter

Recommendation for Use

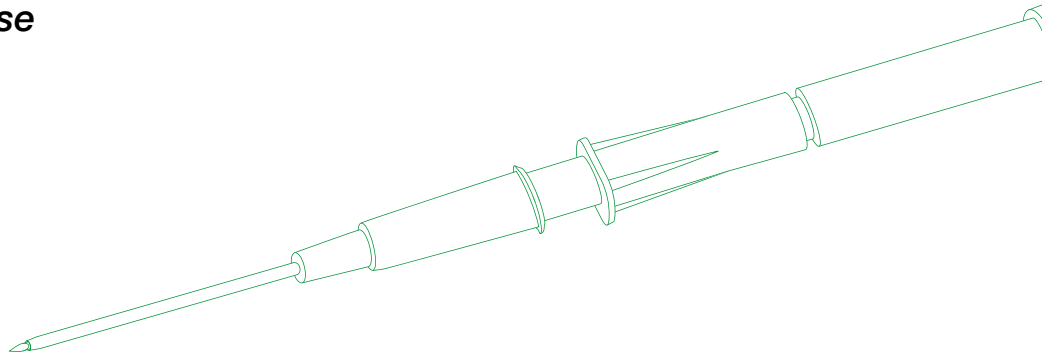

Preparation

- 1
 - Prepare and disinfect the puncture site according to local hospital policy and make sure all items are ready.
 - Remove the I.V. catheter from the packaging and remove the cover from the needle just before use.
 - Do not touch the catheter prior to use.

Placement

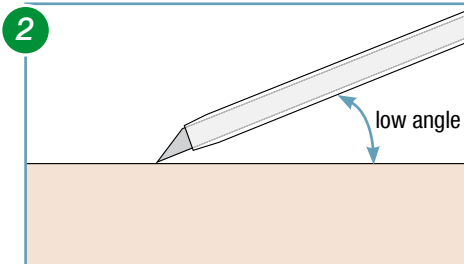

Approach vein in a low angle.

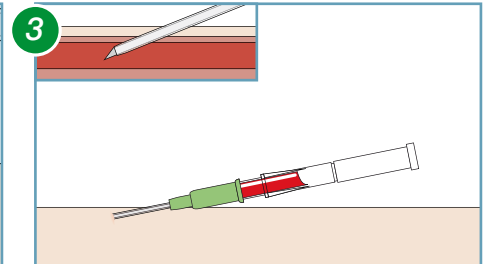

Flashback confirms proper placement. After confirmation decrease angle to nearly same level with the skin. Move catheter 2 to 3 mm forward to ensure catheter point is in the vein.

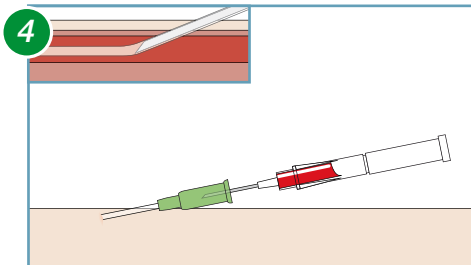

Hold the needle and forward the catheter into the vein.

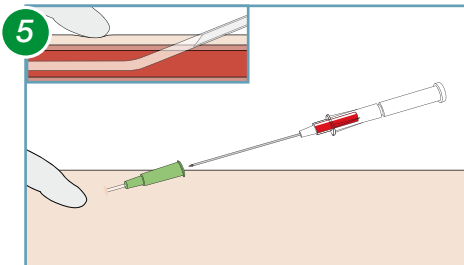

Give pressure with your index or middle finger on the vein at the catheter tip while withdrawing the needle completely.

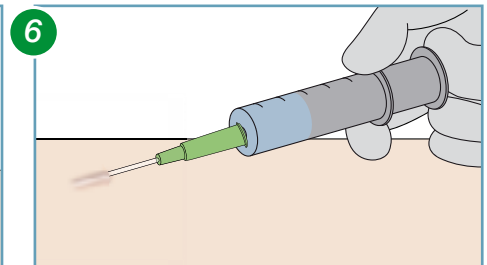

Flush the catheter after placement.

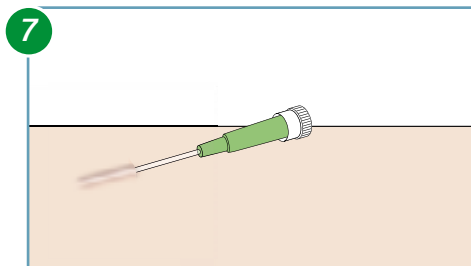

Close the catheter hub with a luer lock cap, another closing system or connect an infusion line.

Proper disposal

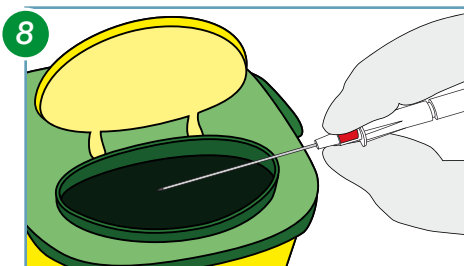

Dispose the inner needle directly after withdrawal into a sharps disposal box.

Fixation

- 9
 - Use proper dressing regimes to fix the catheter according to hospitals guidelines.

This document is an overview and not intended to be comprehensive.

Terumo Europe N.V
Researchpark Haasrode 1520
Interleuvenlaan 40
3001 Leuven, Belgium

Phone: +32 16 38 12 11
Fax: +32 16 40 02 49
<http://www.terumo-europe.com>
hospital.systems@terumo-europe.com